

Direction:

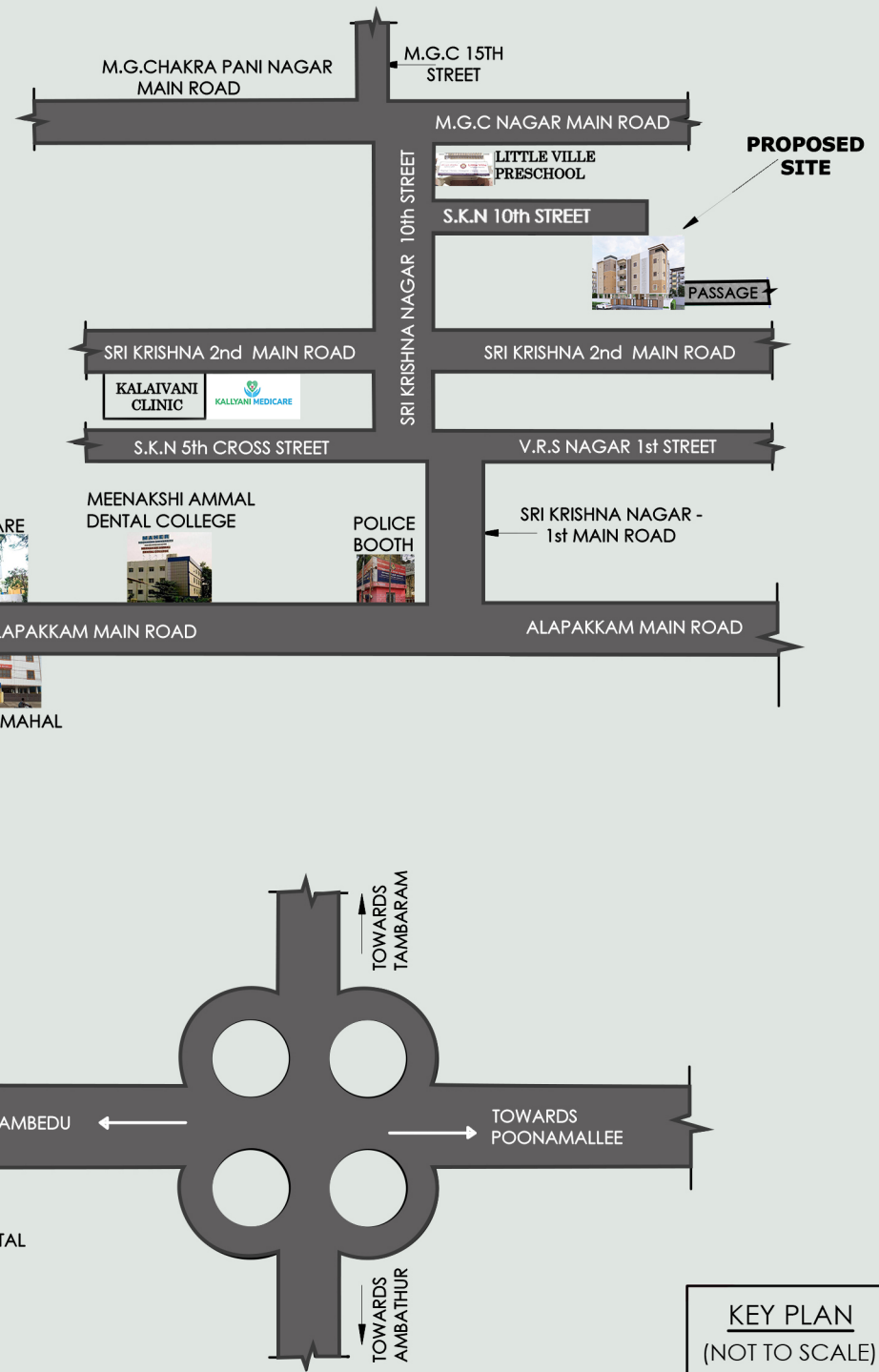

M/S. VINOOTH BUILDERS -
PROPOSED RESIDENTIAL
APARTMENT PROJECT "VINOOTH
VARUNI" AT VALASARAVAKKAM,
CHENNAI



PROMOTED BY



KEY PLAN
(NOT TO SCALE)

PROMOTED BY



"VINOOTH VARUNI"
AT VALASARAVAKKAM,
CHENNAI

STILT FLOOR PLAN

Direction:

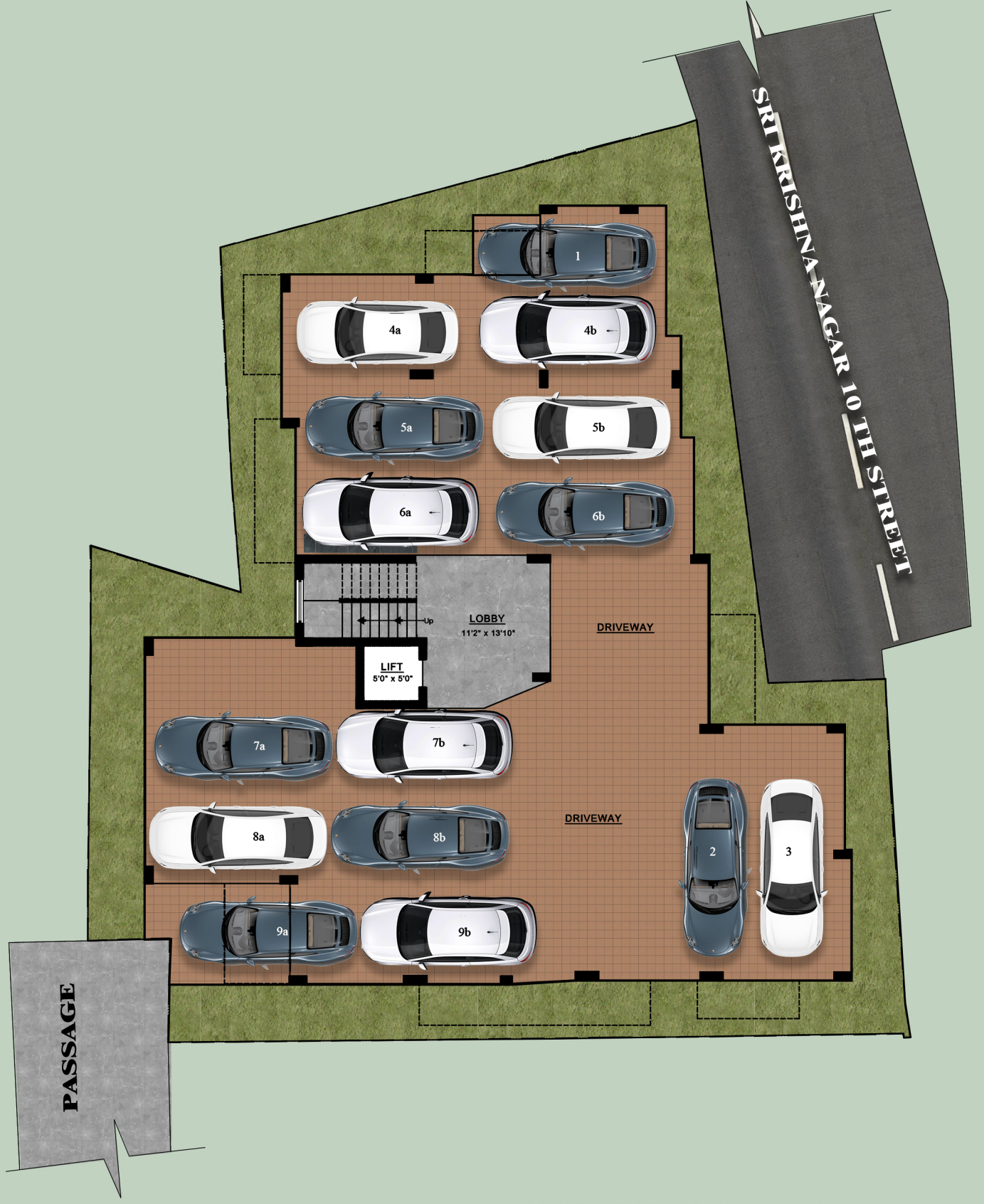

PROMOTED BY



"VINOOTH VARUNI" AT VALASARAVAKKAM, CHENNAI

TYPICAL FLOOR PLAN (FIRST/ SECOND/ THIRD)

Direction:



"VINOOTH VARUNI"
AT VALASARAVAKKAM,
CHENNAI

F1/S1/T1
1383 Sq.ft
3BHK

Direction:

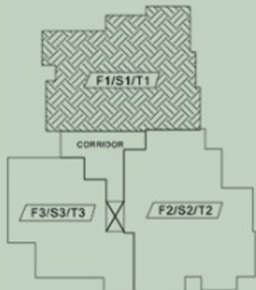

KEY PLAN - TYPICAL FLOOR
(NOT TO SCALE)



PROMOTED BY



UNIT FLOOR PLAN
(FIRST/ SECOND/ THIRD)

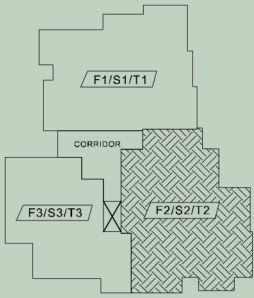

KEY PLAN - TYPICAL FLOOR
(NOT TO SCALE)

"VINOOTH VARUNI"
AT VALASARAVAKKAM,
CHENNAI

F2/S2/T2
1445 Sq.ft
3BHK

Direction:



PROMOTED BY



UNIT FLOOR PLAN
(FIRST/ SECOND/ THIRD)

"VINOOTH VARUNI"
AT VALASARAVAKKAM,
CHENNAI

F3/S3/T3
1008 Sq.ft
2BHK

Direction:

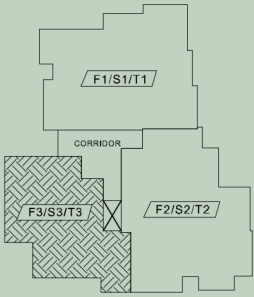

KEY PLAN - TYPICAL FLOOR
(NOT TO SCALE)



PROMOTED BY



UNIT FLOOR PLAN
(FIRST/ SECOND/ THIRD)